

FLAP VALVE - KVF NPS/OD 4-6

AREA OF USE: With flange for wall mounting. Barrier against backflow in the piping system. Discharge from drainage systems to open channels and pump stations. KVF is for one-way flow.

ADVANTAGES WITH WAFLAP KVF:

- The flap valve can be mounted below the water surface
- The materials are corrosion-resistant with low maintenance requirements
- Easy opening in the direction of flow, and the flap closes securely in the opposite direction
- Without mechanics, thereby allowing for easy installation

INSTALLATION: Mounted on a maintenance-free, heavy-duty rubber hinge with embedded canvas that is not affected by reduced friction from the surroundings. The slanted flap (inclination 15°) is mounted on a maintenance-free, heavy-duty rubber hinge with embedded fabric, which is not affected by reduced friction from the environment, thereby a lower hydraulic resistance in the direction of flow. Soft seal mounted against the flap.



MATERIAL:

Pipe to flap valve	PEHD
Flap and wall flange	PEHD
Weight and reinforcement	EN 1.4404
Hinge rubber	EP 400/3-3+1,5 LD
Hinge bracket	EN 1.4404
Seal against the flap	EPDM
Seal against wall	EPDM sponge rubber

TECHNICAL DATA:

Pressure ratio	0,5 bar
Temperatur	-50°C - +80°C

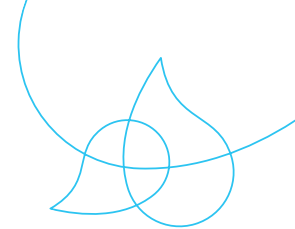

FLAP VALVE - KVF NPS/OD 4-6

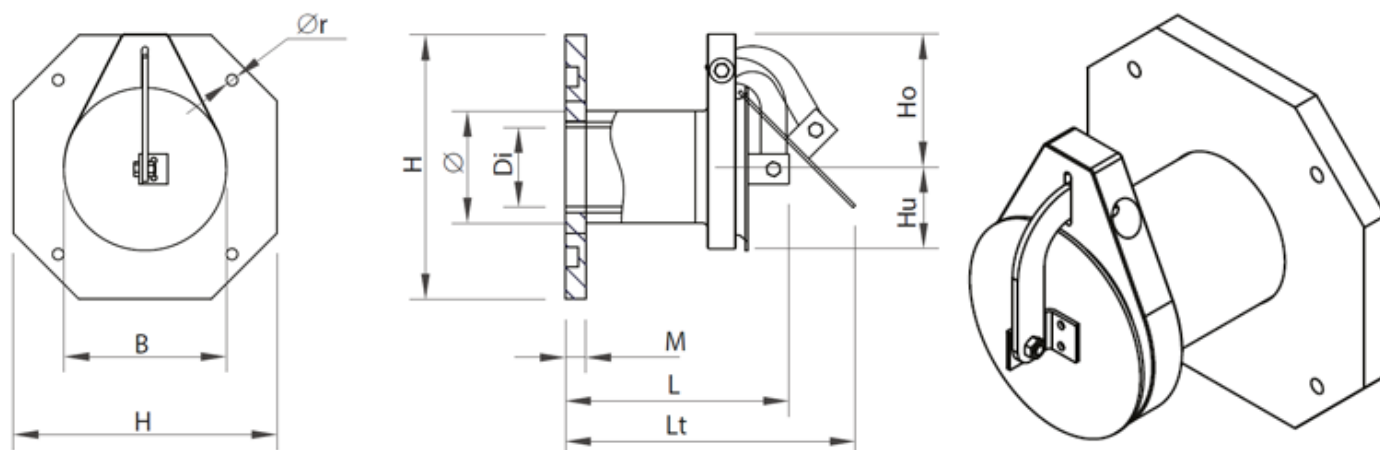

DIMENSIONS IN [INCHES]

NPS/OD	Ø	H	Di	B	M	L	Lt	Ør	VIKT[KG]	RØRTYPE
4	4	10,2	4	6,3	0,8	8,7	13	8xØ11	3,3	SDR 26
5	5	10,6	4,5	7,1	1,2	8,7	13,4	8xØ11	4,4	SDR 26
6	6	12,8	5,8	7,9	1,2	9,1	13,8	8xØ11	6,6	SDR 26

Other dimensions on request. Reserves the right to changes.